



## AVK HANDWHEEL, CTC

08/A-004

To suit Series 06, 21, 37, 54 and 55 gate valves



For manual operation of AVK gate valves and AVK service connection valves AVK recommends usage of our handwheels. AVK handwheels are of grey cast iron GJL-250 (GG-25) with epoxy coating to DIN 30677.



### Product description:

Handwheel assembled with A2 bolt and washer



### Features:

- Handwheel for gate valves in blue epoxy 250 micron.



Expect ... **AVK**

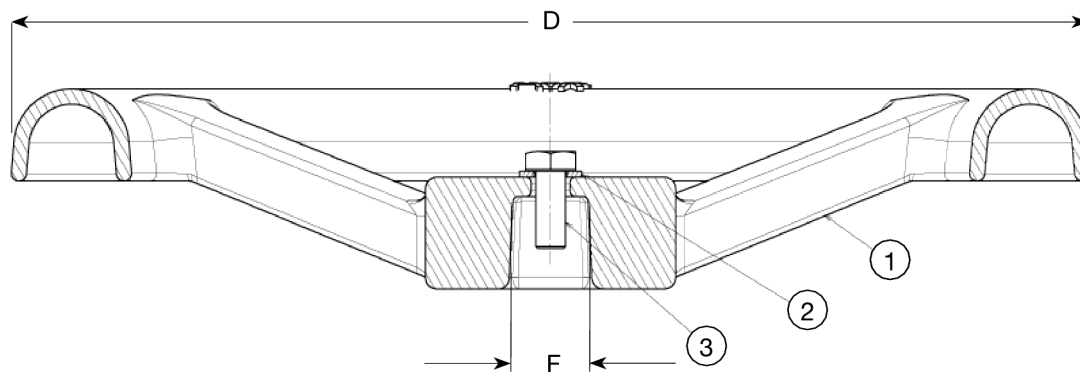

**Component list:**

1. Handwheel	Cast iron GJL-250	3. Bolt	Stainless steel A2
2. Washer	Stainless steel A2		

Components may be substituted with equivalent or higher class materials without prior notification.

**Reference nos. and dimensions:**

AVK ref. no.	Used on	DN/DN	D mm	F mm	Theoretical weight / kg
08-080-02-000	Series 06	65-80	225	17	2.0
08-080-05-000	Series 21/35, 21/50	50-100	225	19	2.0
08-100-01-000	Series 21/35, 21/50	50-100	280	19	3.5
08-150-02-000	Series 21/35	150-200	320	19	4.5
08-200-00-000	Series 21/50, 37	150	360	24	6.0
08-200-01-000	Series 21/50, 37	200	360	27	6.8
08-250-02-000	Series 21/50	250-300	500	27	11
08-400-01-000	Series 21/50, 55	350-400	640	32	17
08-400-01-00002	Series 54	350-600	640	32	17