



AVK SWING CHECK VALVE, RESILIENT SEATED, PN10/16

41/20-001

Right side free shaft end

AVK series 41 swing check valves come with both metal and resilient seats. Installed in pumping applications to prevent back flow they can be used for drinking water as well as waste water. The disc is connected to the shaft via a flexible bush that allows disc and valve seat to adjust exactly. All interior parts are stainless steel or coated with drinking water approved epoxy or EPDM. The series 41 valves are available with either closed bushings or protruding shaft end where a lever with a weight or a spring can be fitted to mitigate pressure surges.

Product description:

Resilient seated swing check valve with free shaft end. For drinking water and neutral liquids to max. 70°C

Design standards:

- EN 1074-3
- Face-to-face dimension according to EN 558 Table 2 Basic Series 10
- Flange drilling to EN1092, PN10/16

Test/Approvals:

- Approved according to WRAS Certificate No. 1811031 Ser. 41

Features:

- Resilient seat provides a drop tight closure and due to the light weight it requires a minimum of force to open/close
- Shaft fitted in the bonnet allowing for easy maintenance without removing valve from pipeline
- Shaft material 1.4021 (AISI 420) stainless steel
- Free protruding shaft end for mounting of lever and weight or spring to assist valve closing and avoid water hammer
- Hinge of stainless steel for sizes \leq DN 200; ductile iron coated with drinking water approved epoxy for larger
- Bonnet gasket in a groove between bonnet and body to prevent blow-out
- All seals and coatings with contact to the fluid are approved for drinking water - coating is blue, 250 μ m fusion bonded epoxy
- Disc is designed with a steel or ductile iron insert fully vulcanized with EPDM rubber
- Bosses on each side of the valve seat allow for installation of pressure gauge, by-pass, etc.

Accessories:

Lever and weight/spring, lever protection guard, proximity switch, combi-flanges, flange adaptors.



Expect... **AVR**

The designs, materials and specifications shown are subject to change without notice due to the continuous development of our product range.

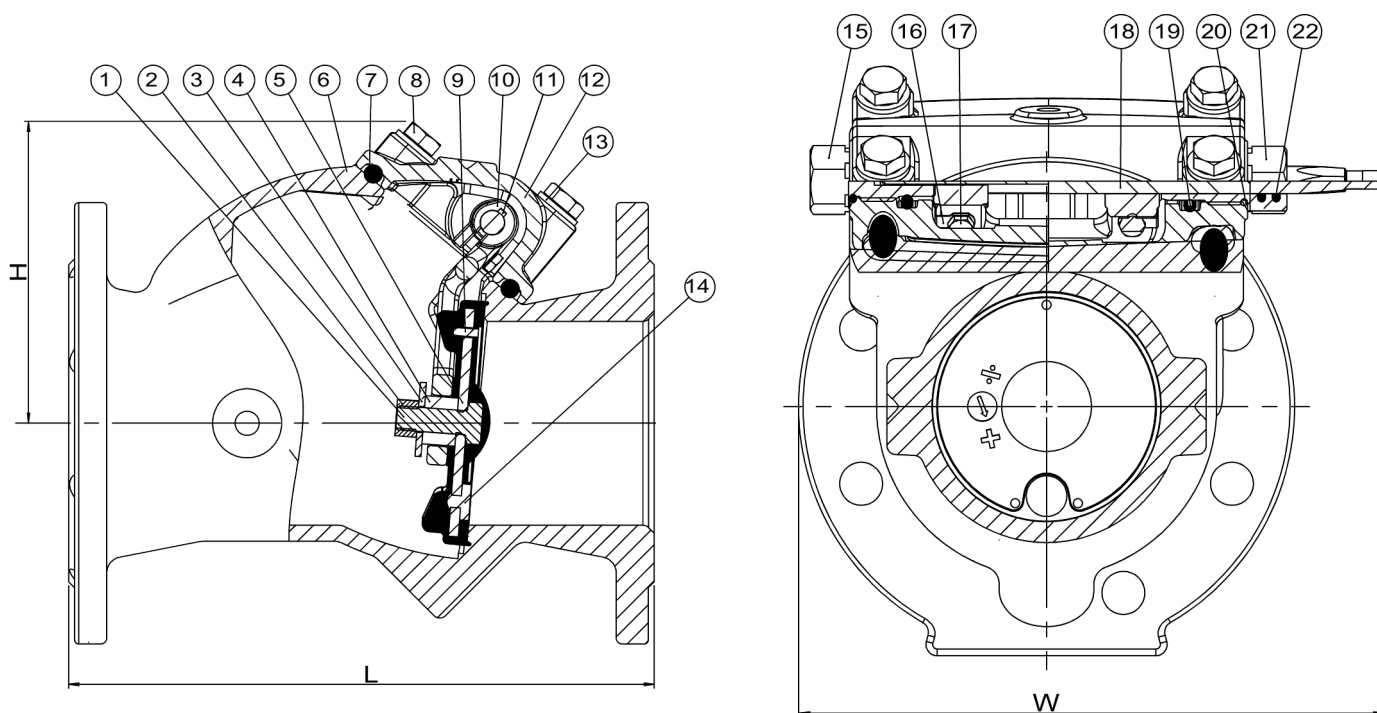

Component list:

1. Bolt	Stainless steel A4	12. Bonnet	Ductile iron GJS-500-7 (GGG-50)
2. Nut	Stainless steel A2	13. Washer	Stainless steel A4
3. Washer	Stainless steel A4	14. Thrust plate	Stainless steel
4. Bushing	Polyamide	15. Bushing, closed	Brass DZR
5. Disc	Steel S235JR	16. Tab washer	Stainless steel A4
6. Body	Ductile iron GJS-500-7 (GGG-50)	17. Bolt	Stainless steel A4
7. Gasket	EPDM rubber	18. Shaft	Stainless steel AISI 420
8. Bolt	Stainless steel A2	19. O-ring	EPDM rubber
9. Pin	Stainless steel A4	20. O-ring	EPDM rubber
10. Hinge	Stainless steel AISI 316	21. Bushing, open	Brass DZR
11. Key	Stainless steel A4	22. O-ring	EPDM rubber

Components may be substituted with equivalent or higher class materials without prior notification.
 Item 10: Ductile iron for DN ≥ 250

Reference nos. and dimensions:

AVK ref. no.	DN mm	Flange drilling	L mm	H mm	W mm	Theoretical weight/kg
41-050-20-018	50	PN10/16	203	110	233	14
41-080-20-018	80	PN10/16	241	140	233	17
41-100-20-018	100	PN10/16	292	150	256	22
41-150-20-018	150	PN10/16	356	195	334	42
41-200-20-008	200	PN10	495	230	386	67
41-200-20-018	200	PN16	495	230	386	67
41-250-20-008	250	PN10	622	270	692	161
41-250-20-018	250	PN16	622	270	692	161
41-300-20-008	300	PN10	698	300	692	238
41-300-20-018	300	PN16	698	300	692	238

The designs, materials and specifications shown are subject to change without notice due to the continuous development of our product range.