



AVK FLANGED TEE PN 10/16

712/1010-001



AVK's range of fittings comprises a wide selection of variants with socket, tyton and flange connection. The fittings are made of ductile iron GJS-500-7 and are epoxy coated according to DIN 30677-2 and GSK specifications - internally and externally.



Product description:

All flanged Tee type T to EN 545 for water, waste water and neutral liquids to max. 70° C

Standards:

- Designed according to EN 545
- Standard flange drilling to EN1092-2 (ISO 7005-2), PN 10/16

Test/Approvals:

- Approved according to ACS-France
- Belgaqua approved material



Features:

- Ductile iron fitting to EN 545
- Body of GJS-500-7
- Epoxy coated to DIN 30677-2 and GSK guidelines internally and externally



Expect... **AVK**

The designs, materials and specifications shown are subject to change without notice due to the continuous development of our product range.

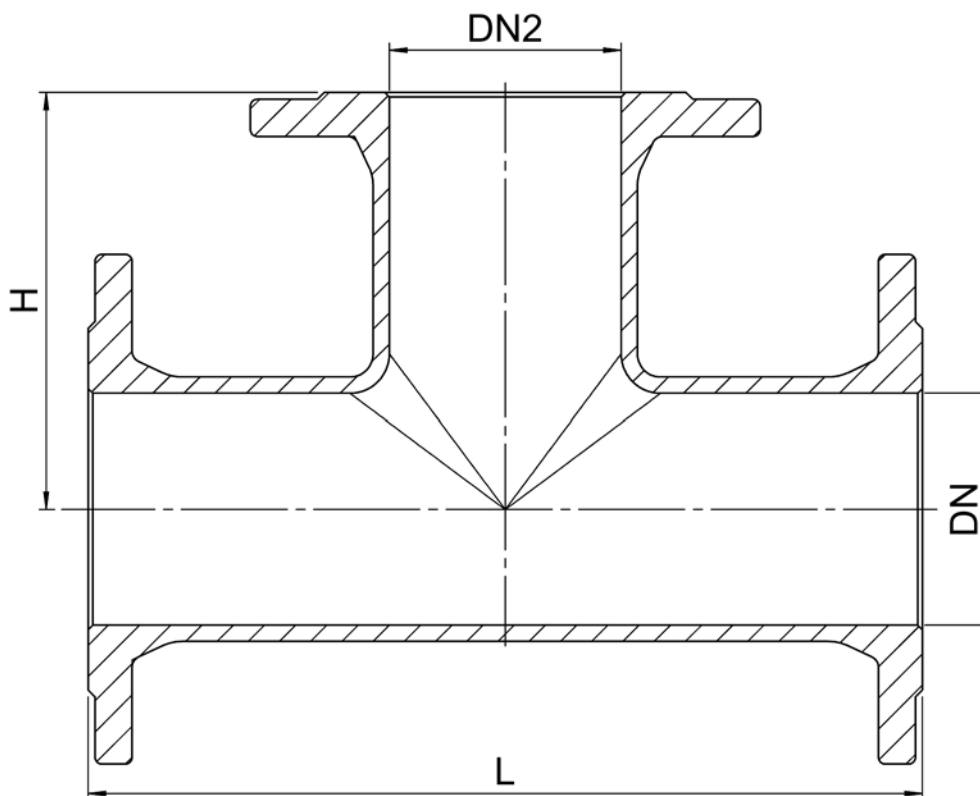

Component list:

1. Fitting	Ductile iron
------------	--------------

Components may be substituted with equivalent or higher class materials without prior notification.

Reference nos. and dimensions:

AVK ref. no.	DN mm	DN2 mm	Flange drilling	L mm	H mm	Theoretical weight/kg
712-0040-10-101	40	40	PN10/16	280	140	8.0
712-0050-10-101	50	50	PN10/16	300	150	9.9
712-0051-10-101	50	40	PN10/16	300	145	9.7
712-0065-10-101	65	65	PN10/16	330	165	15
712-0066-10-101	65	50	PN10/16	330	158	12
712-0067-10-101	65	40	PN10/16	330	153	12
712-0080-10-101	80	80	PN10/16	330	165	14
712-0081-10-101	80	65	PN10/16	310	155	15
712-0082-10-101	80	50	PN10/16	330	160	13
712-0083-10-101	80	40	PN10/16	310	135	14
712-0100-10-101	100	100	PN10/16	360	180	18
712-0101-10-101	100	80	PN10/16	360	175	17
712-0102-10-101	100	65	PN10/16	360	170	17
712-0103-10-101	100	50	PN10/16	360	170	16
712-0104-10-101	100	40	PN10/16	320	145	17
712-0125-10-101	125	125	PN10/16	400	200	23
712-0126-10-101	125	100	PN10/16	400	195	21
712-0127-10-101	125	80	PN10/16	400	190	21
712-0128-10-101	125	65	PN10/16	400	185	21
712-0129-10-101	125	50	PN10/16	400	185	20
712-0130-10-101	125	40	PN10/16	330	160	21
712-0150-10-101	150	150	PN10/16	440	220	29
712-0151-10-101	150	125	PN10/16	440	215	30
712-0152-10-101	150	100	PN10/16	440	210	26
712-0153-10-101	150	80	PN10/16	440	205	25
712-0154-10-101	150	65	PN10/16	340	180	24

The designs, materials and specifications shown are subject to change without notice due to the continuous development of our product range.

Reference nos. and dimensions:

AVK ref. no.	DN mm	DN2 mm	Flange drilling	L mm	H mm	Theoretical weight/kg
712-0155-10-101	150	50	PN10/16	340	180	23
712-0200-10-100	200	200	PN10	520	260	43
712-0200-10-101	200	200	PN16	520	260	42
712-0201-10-100	200	150	PN10	520	250	39
712-0201-10-101	200	150	PN16	520	250	39
712-0202-10-100	200	125	PN10	435	240	47
712-0202-10-101	200	125	PN16	435	240	47
712-0203-10-100	200	100	PN10	520	240	37
712-0203-10-101	200	100	PN16	520	240	37
712-0204-10-100	200	80	PN10	520	235	44
712-0204-10-101	200	80	PN16	520	235	36
712-0250-10-100	250	250	PN10	700	350	69
712-0250-10-101	250	250	PN16	700	350	69
712-0251-10-100	250	200	PN10	700	325	64
712-0251-10-101	250	200	PN16	700	325	64
712-0252-10-100	250	150	PN10	700	300	60
712-0252-10-101	250	150	PN16	700	300	60
712-0254-10-100	250	100	PN10	700	275	57
712-0254-10-101	250	100	PN16	700	275	57
712-0255-10-100	250	80	PN10	700	265	59
712-0255-10-101	250	80	PN16	700	265	59
712-0300-10-100	300	300	PN10	800	400	127
712-0300-10-101	300	300	PN16	800	400	98
712-0301-10-100	300	250	PN10	620	330	79
712-0301-10-101	300	250	PN16	620	330	79
712-0302-10-100	300	200	PN10	800	350	85
712-0302-10-101	300	200	PN16	800	350	85
712-0303-10-100	300	150	PN10	505	310	64
712-0303-10-101	300	150	PN16	505	310	64
712-0305-10-100	300	100	PN10	800	300	78
712-0305-10-101	300	100	PN16	800	300	78
712-0306-10-100	300	80	PN10	800	290	81
712-0306-10-101	300	80	PN16	800	290	81
712-0349-10-100	350	300	PN10	850	425	136
712-0349-10-101	350	300	PN16	850	425	136
712-0350-10-100	350	350	PN10	850	425	165
712-0350-10-101	350	350	PN16	850	425	165
712-0352-10-100	350	250	PN10	645	360	142
712-0352-10-101	350	250	PN16	645	360	142
712-0353-10-100	350	200	PN10	850	325	138
712-0353-10-101	350	200	PN16	850	325	138
712-0354-10-100	350	150	PN10	530	340	134
712-0354-10-101	350	150	PN16	530	340	134
712-0356-10-100	350	100	PN10	850	325	131
712-0356-10-101	350	100	PN16	850	325	131
712-0357-10-100	350	80	PN10	445	325	130
712-0357-10-101	350	80	PN16	445	325	130
712-0400-10-100	400	400	PN10	900	450	207
712-0400-10-101	400	400	PN16	900	450	207
712-0401-10-100	400	350	PN10	900	450	198
712-0401-10-101	400	350	PN16	900	450	198
712-0402-10-100	400	300	PN10	725	400	160
712-0402-10-101	400	300	PN16	725	400	160
712-0403-10-100	400	250	PN10	665	390	175
712-0403-10-101	400	250	PN16	665	390	140
712-0404-10-100	400	200	PN10	900	350	150
712-0404-10-101	400	200	PN16	900	350	150
712-0405-10-100	400	150	PN10	550	370	168
712-0405-10-101	400	150	PN16	550	370	168
712-0407-10-100	400	100	PN10	900	350	165
712-0407-10-101	400	100	PN16	900	350	165

The designs, materials and specifications shown are subject to change without notice due to the continuous development of our product range.

Reference nos. and dimensions:

AVK ref. no.	DN	DN2	Flange	L	H	Theoretical
	mm	mm	drilling	mm	mm	weight/kg
712-0408-10-100	400	80	PN10	470	355	164
712-0408-10-101	400	80	PN16	470	355	164
712-0500-10-100	500	500	PN10	1000	500	326
712-0500-10-101	500	500	PN16	1000	500	326
712-0502-10-100	500	400	PN10	1000	500	299
712-0502-10-101	500	400	PN16	1000	500	299
712-0504-10-100	500	300	PN10	1000	500	281
712-0504-10-101	500	300	PN16	1000	500	281
712-0505-10-100	500	250	PN10	1000	400	269
712-0505-10-101	500	250	PN16	1000	400	269
712-0506-10-100	500	200	PN10	1000	400	265
712-0506-10-101	500	200	PN16	1000	400	265
712-0507-10-100	500	150	PN10	1000	400	262
712-0507-10-101	500	150	PN16	1000	400	262
712-0509-10-100	500	100	PN10	1000	400	259
712-0509-10-101	500	100	PN16	1000	400	259
712-0600-10-100	600	600	PN10	1100	550	477
712-0600-10-101	600	600	PN16	1100	550	477
712-0603-10-100	600	400	PN10	1100	550	418
712-0603-10-101	600	400	PN16	1100	550	418
712-0605-10-100	600	300	PN10	1100	550	402
712-0605-10-101	600	300	PN16	1100	550	402
712-0607-10-100	600	200	PN10	1100	450	385
712-0607-10-101	600	200	PN16	1100	450	385
712-0610-10-100	600	100	PN10	1100	450	380
712-0610-10-101	600	100	PN16	1100	450	380